

GENERAL DRAWING

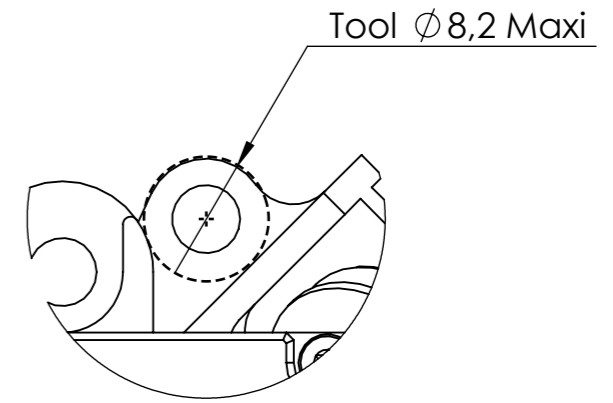

Detailed view A

SCALE 2 : 1

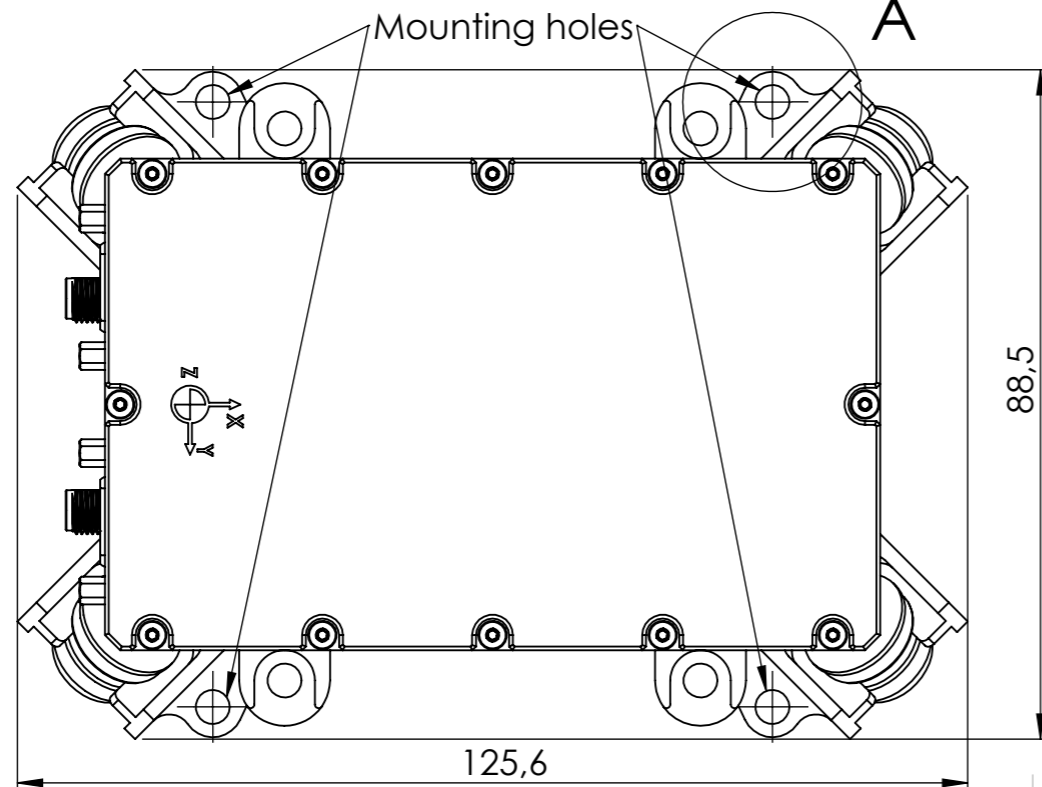
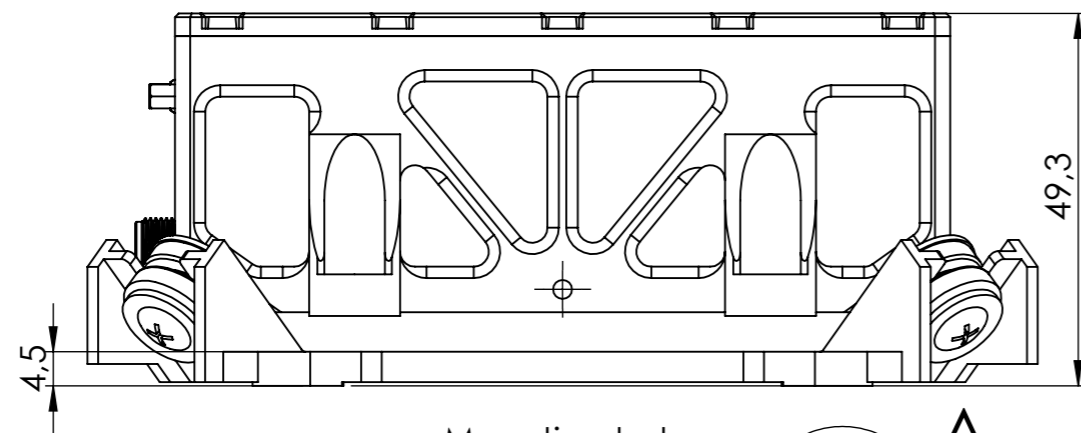
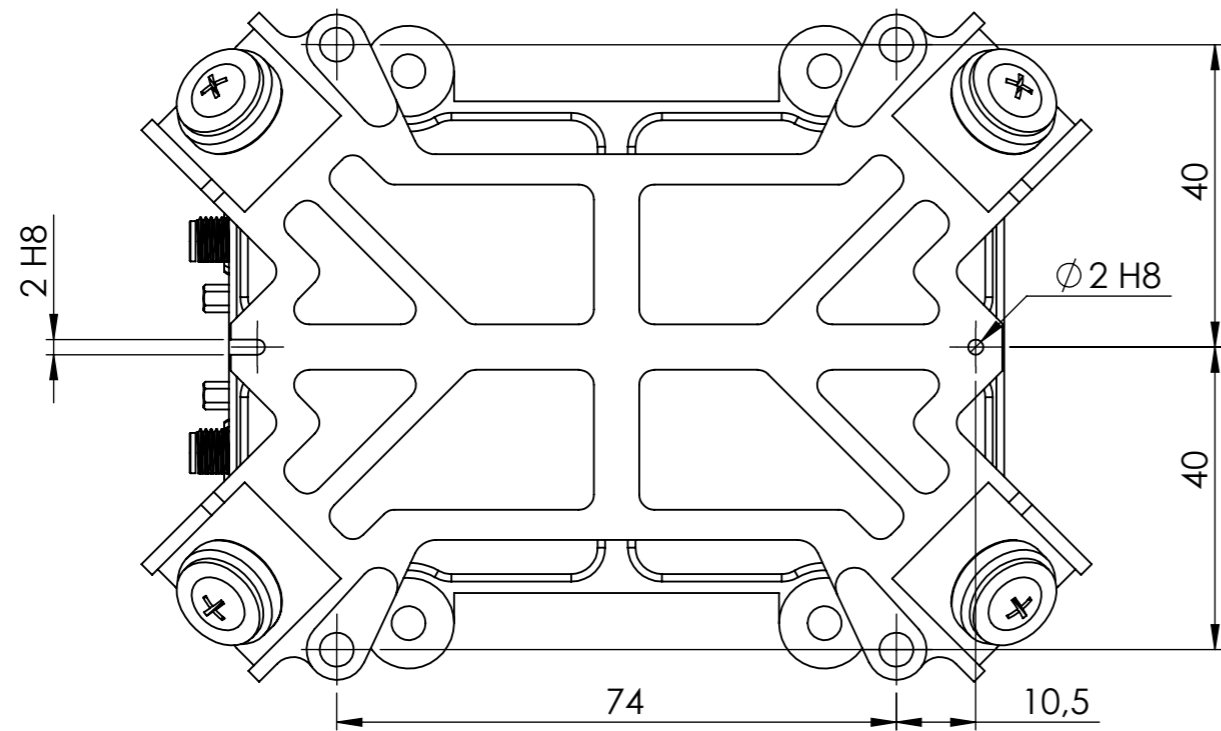
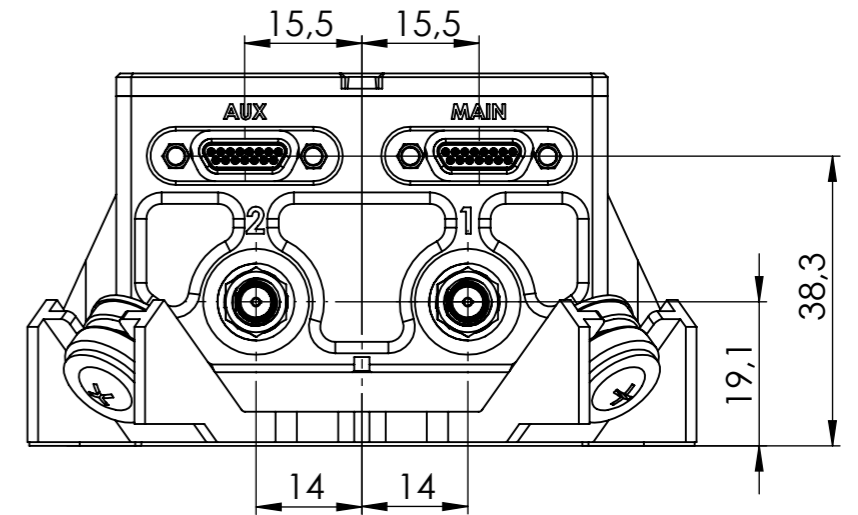

NOTA : All dimension are in millimeters

This document is the exclusive property of SBG-Systems and may not be reproduced or communicated to third parties without written authorization.



Designation :
STELLAR40-Damped-Customer-Drawing

Drawing N°: drw-SBG-00001791	Revision: B	Maturity state : Released
---------------------------------	----------------	------------------------------

Assembly Part N° : prd-SBG-00017109
Revision: E

1 AVENUE EIFFEL
78420, CARRIERE SUR SEINE
FRANCE

Material : N/A	Weight (g) : 443g	Treatment : N/A
----------------	-------------------	-----------------

TOL. : I SO 2768-1; ISO 22081	Format : A3	Scale : 1:1	Sheet: 1/4
-------------------------------	-------------	-------------	------------

ORIGIN OF MEASUREMENT

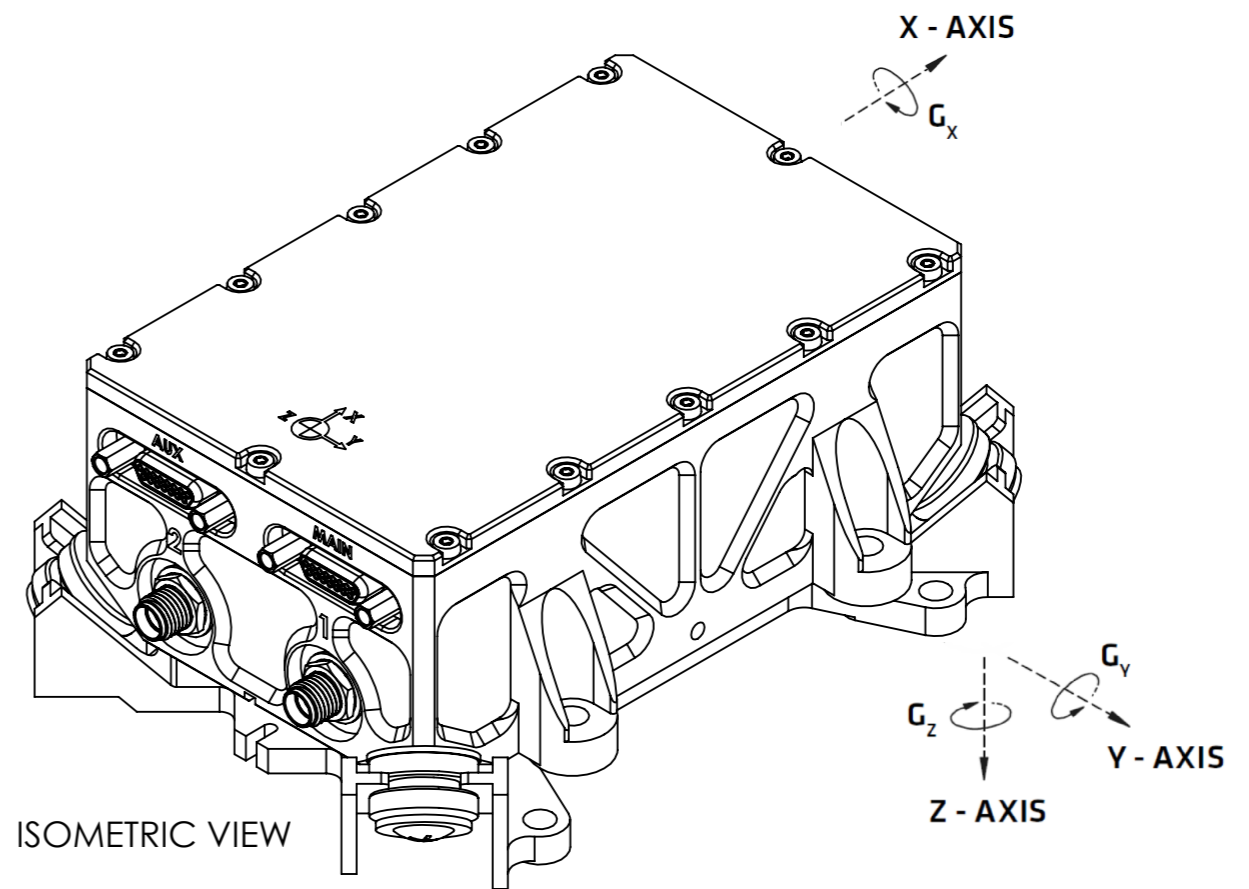
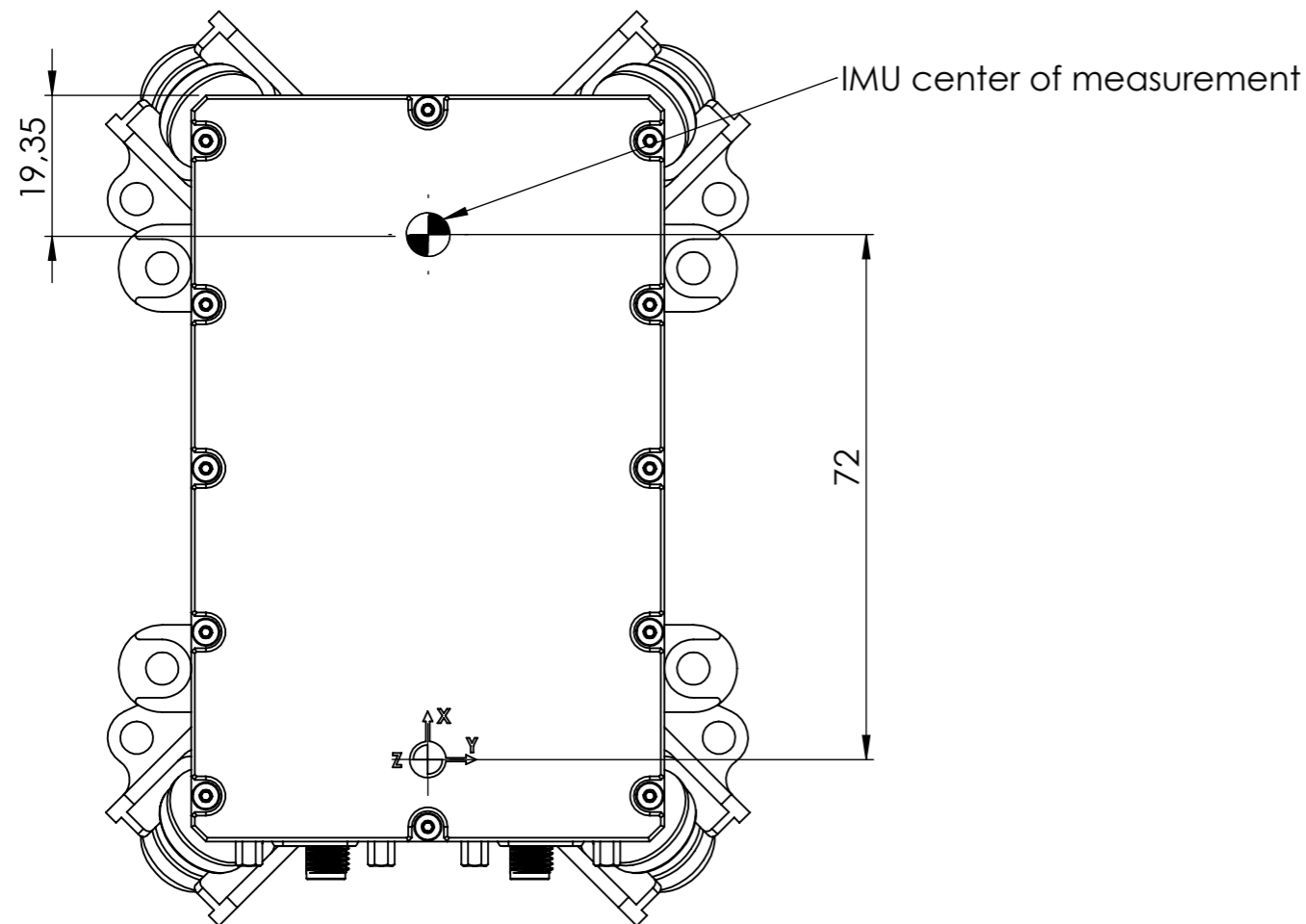
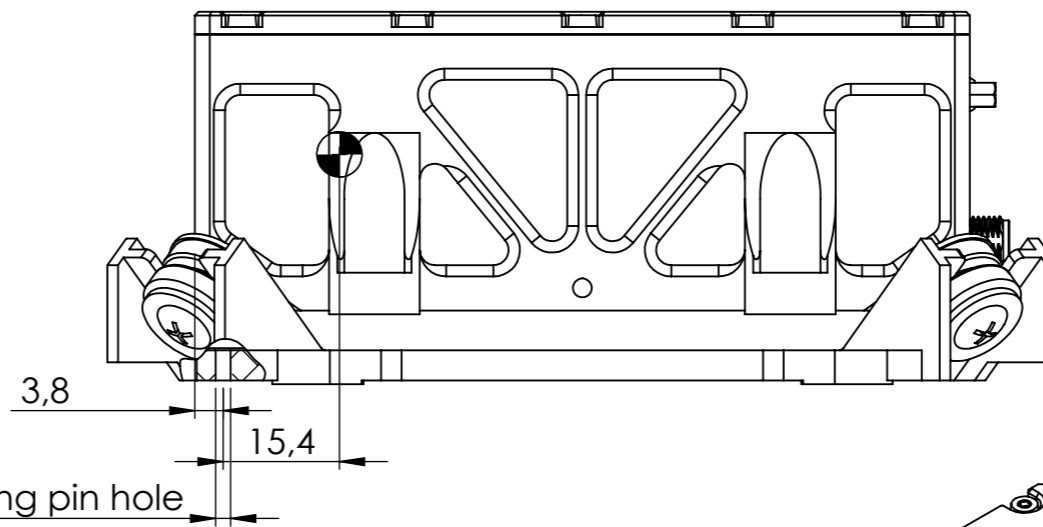
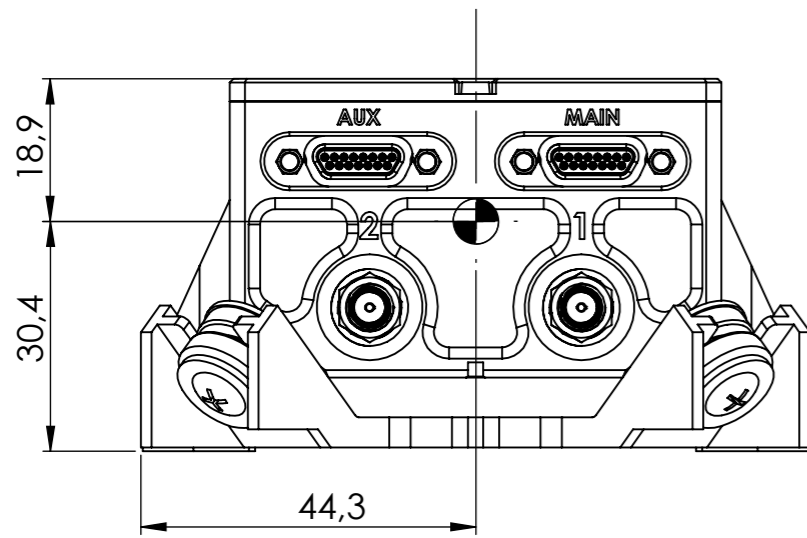

NOTA : All dimension are in millimeters

This document is the exclusive property of SBG-Systems and may not be reproduced or communicated to third parties without written authorization.



Designation :
STELLAR40-Damped-Customer-Drawing

Drawing N°:
drw-SBG-00001791

Revision:
B

Maturity state :
Released

Assembly Part N° : prd-SBG-00017109
Revision: E

1 AVENUE EIFFEL
78420, CARRIERE SUR SEINE
FRANCE

Material : N/A

Weight (g) : 443g

Treatment : N/A

TOL. : ISO 2768-1; ISO 22081

Format : A3

Scale : 1:5

Sheet: 2/4

EXAMPLE OF MOUNTING INTERFACE

ISOMETRIC VIEW

4x DIN912 M4x14mm A2/A4-70
Torque = 2.2N.m
Loctite® 243

Customer shielding braid
For strong EMI compliance

1x DIN912 M3x6mm A2/A4-70
Torque = 0.8N.m
Loctite® 243

2x Øg6 locating pins
defined by the customer
If angular accuracy is critical

max pin height :4,5

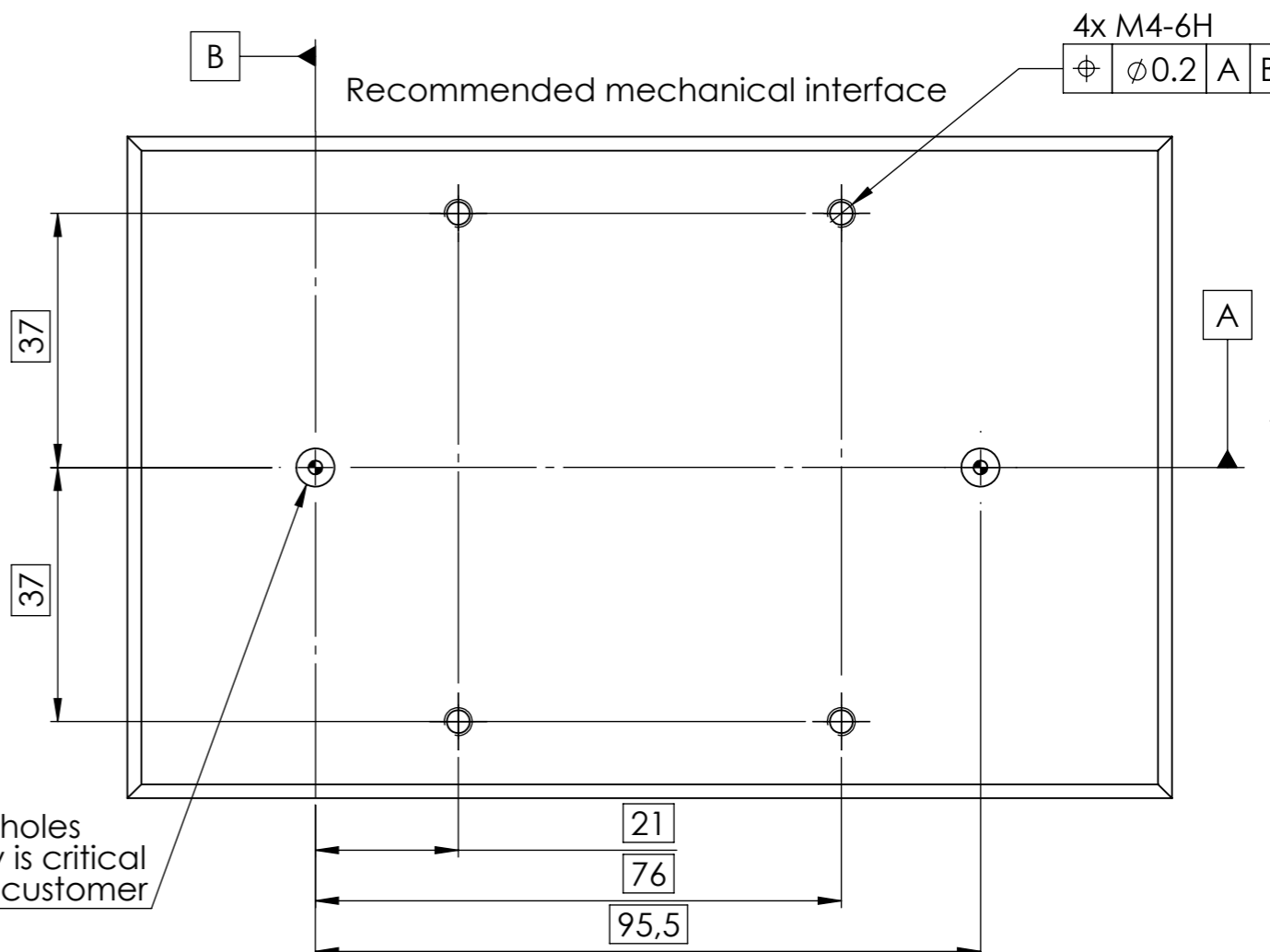
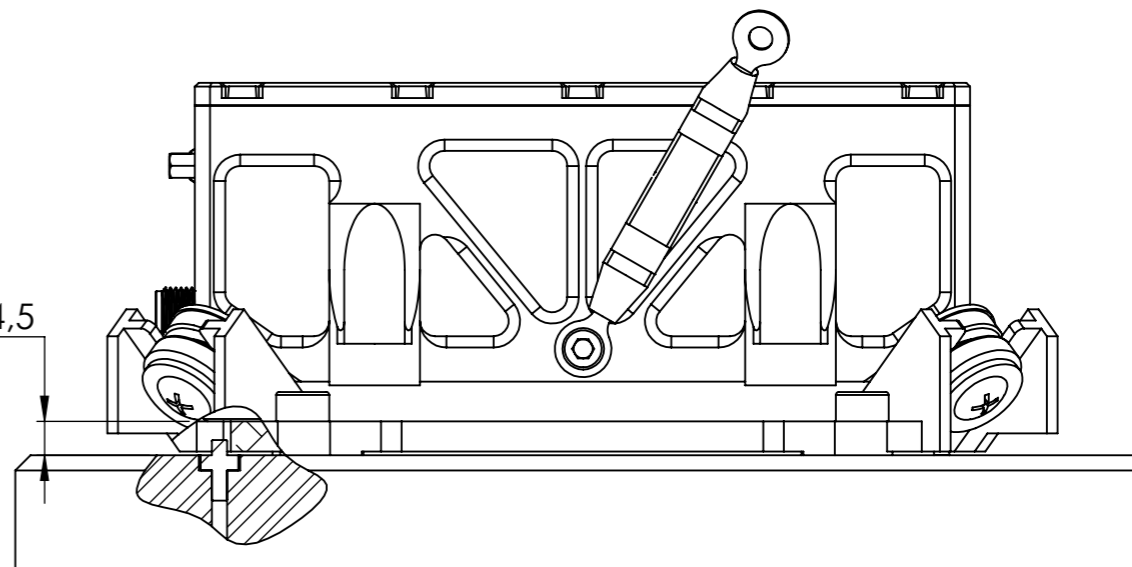

NOTA : All dimension are in millimeters

This document is the exclusive property of SBG-Systems and may not be reproduced or communicated to third parties without written authorization.



Designation :
STELLAR40-Damped-Customer-Drawing

Drawing N°:
drw-SBG-00001791

Revision:
B

Maturity state :
Released

Assembly Part N° : prd-SBG-00017008
Revision: B

1 AVENUE EIFFEL
78420, CARRIERE SUR SEINE
FRANCE

Material : N/A

Weight (g) : 443g

Treatment : N/A

TOL. : I SO 2768-1; ISO 22081

Format : A3

Scalle : 1:1

Sheet: 3/4

GROMMETS ASSEMBLY

Bill of materials

No. ARTICLE	Title	QTY
1	STELLAR 40 BASE	1
2	Grommet	4
3	WASHER-LL-M3	4
4	STELLAR 40-Rigid	1
5	SCREW	4
6	Washer Z M3 NFE 25513	4

REVISION TABLE

Revision	Change	Date
Rev A	Create	
Rev B	First released version	2026-05-26

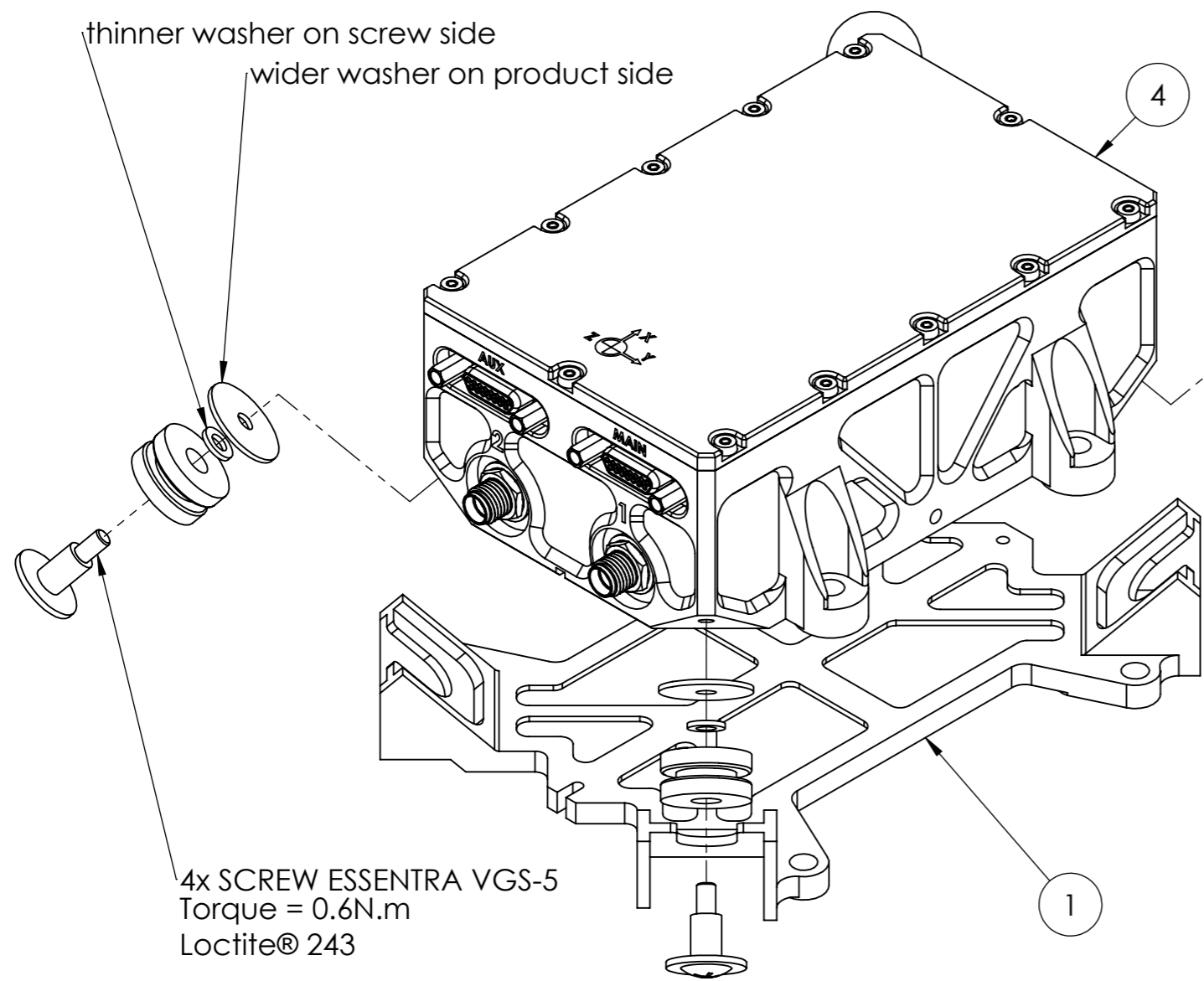

ISOMETRIC VIEW

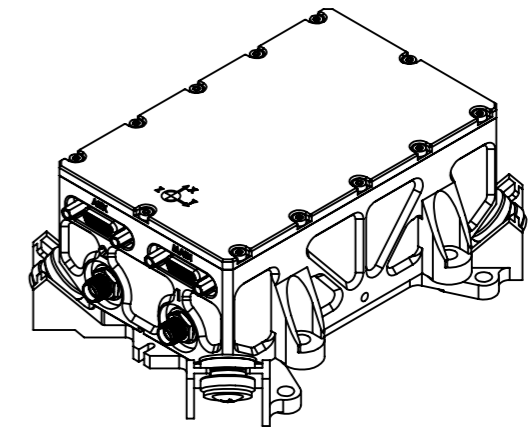
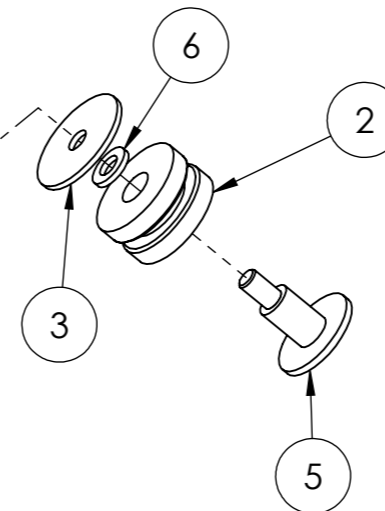

NOTA : All dimension are in millimeters

This document is the exclusive property of SBG-Systems and may not be reproduced or communicated to third parties without written authorization.



Designation :
STELLAR40-Damped-Customer-Drawing

Drawing N°: drw-SBG-00001791	Revision: B	Maturity state : Released
---------------------------------	----------------	------------------------------

1 AVENUE EIFFEL
78420, CARRIERE SUR SEINE
FRANCE

Assembly Part N° : prd-SBG-00017109
Revision: E

Material : N/A	Weight (g) : 443g	Treatment : N/A
----------------	-------------------	-----------------

TOL. : I SO 2768-1; ISO 22081	Format : A3	Scalle : 1:1	Sheet: 4/4
-------------------------------	-------------	--------------	------------